

**baby lock**

*Triumph*

## RevolutionAir Needle Threading Guide Instructions

Part No.: BLET88-NTG

This guide is designed to aid if having difficulties with needle eye thread placement when using the Revolution Air Needle Threader.

### INSTRUCTIONS FOR ATTACHING TO MACHINE:

1. Lower the presser foot for threading the needle eye.
2. Open the front cover and the blade cover.
3. Set the threading lever from serging position to threading position.
4. Rotate the machine handwheel slowly toward you until it is in the locked position.
5. Press the needle threading lever to the down position.

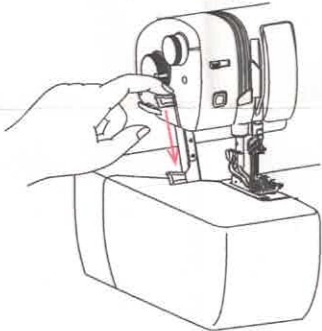

6. Make sure the needle threading inlet is set completely against the back of the needles.
7. Clip the upper section of the RevolutionAir Needle Threading Guide onto the needle bar and the guide's lower section against the needle clamp.

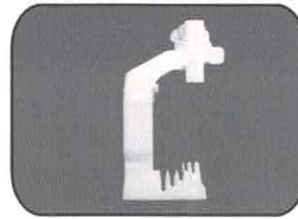
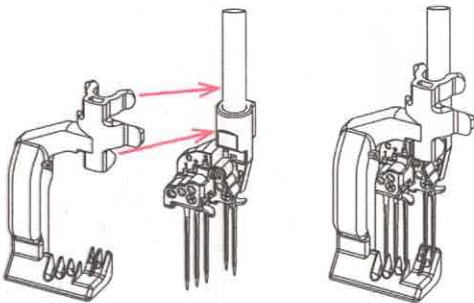

8. Set the needle threader selector lever to Chain(Cover) or Over Lock, whichever is applicable.
9. Press the "Push to thread needles" button to activate the threading pump while holding the thread end directly in front of the needle eye. The thread end will be pulled into needle eye. If threading pump shuts off before threading is completed, press the button again.

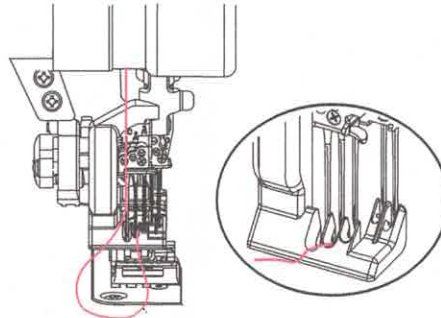

10. Raise the needle threading lever to the up position.

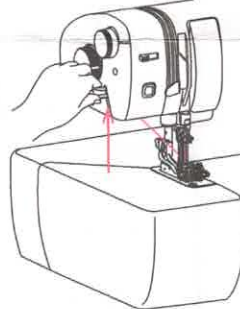

11. Carefully remove the thread from the inlet.
12. Remove the RevolutionAir Needle Threading Guide.

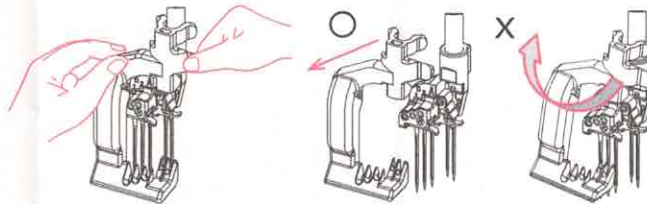

\* Take it off from the front.

13. Set the threading lever to serging position.
14. Close the blade cover and the front cover.

NOTE: The elastic applicator foot cannot be attached when using the "RevolutionAir Needle Threading Guide"

**baby lock**

**FOR THE LOVE OF SEWING**